

Montageanleitung Komplett Dusche "Helena II"

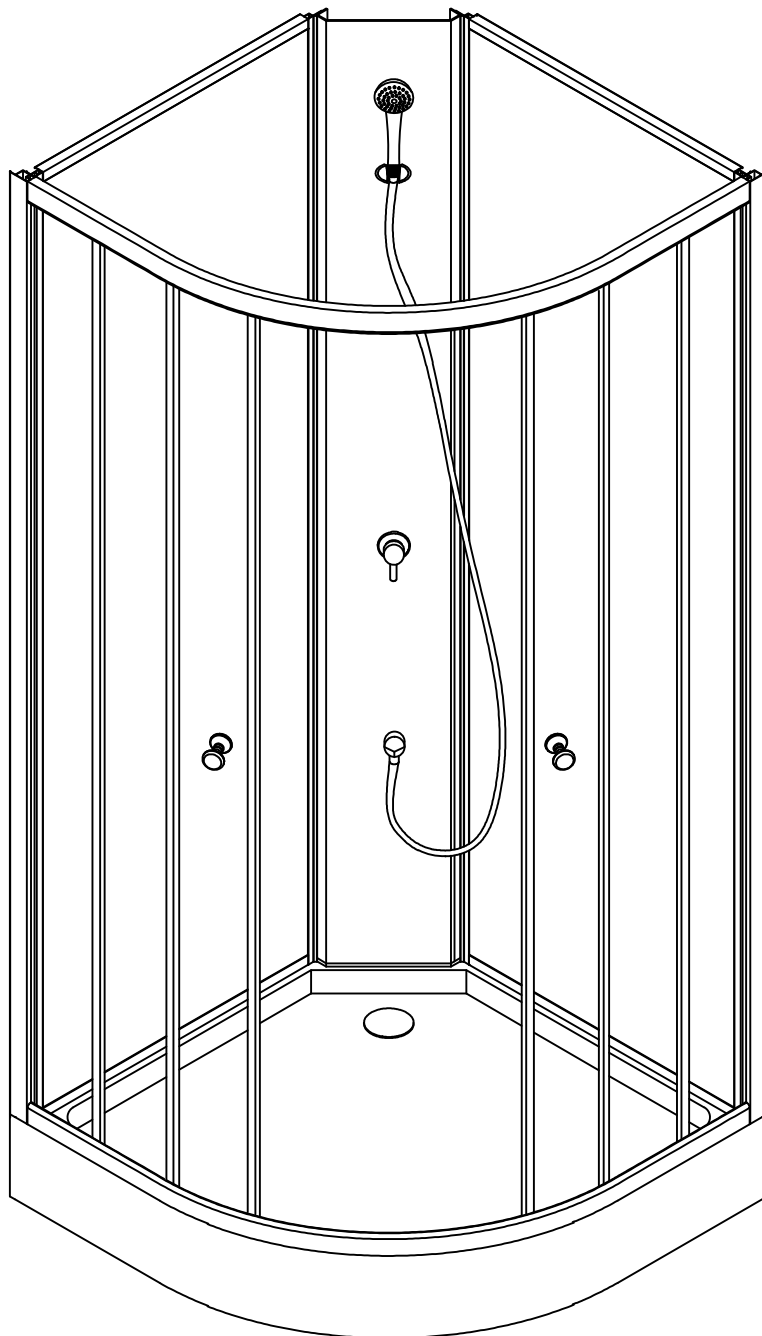

850 x 850 x 2000 mm

Artikelnummer: DM2085EG1152085EQA



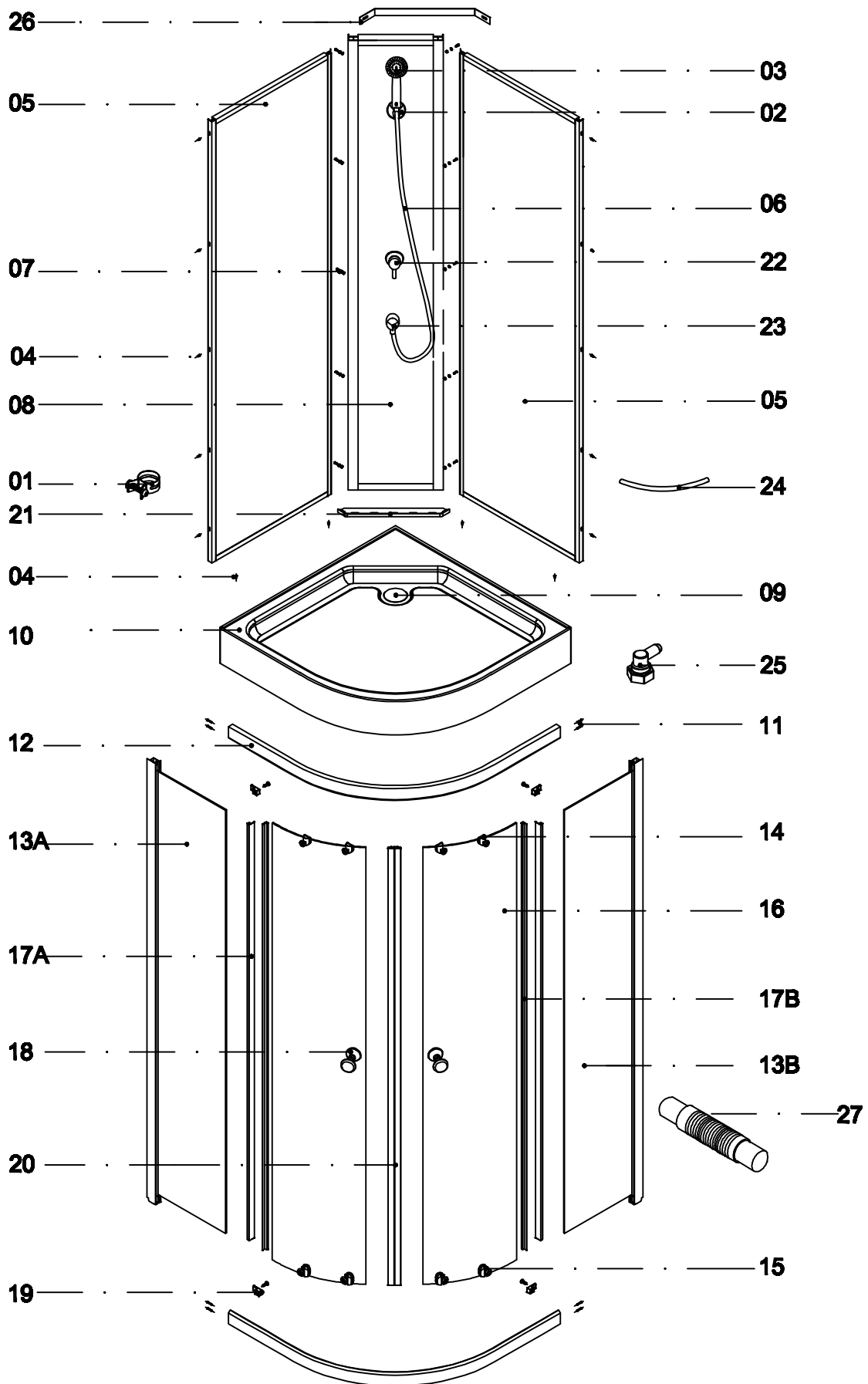

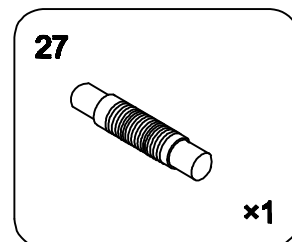
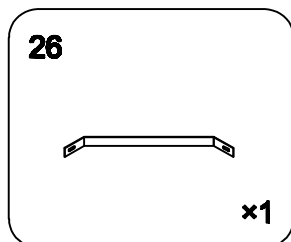
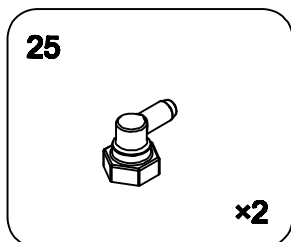
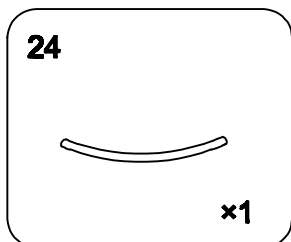
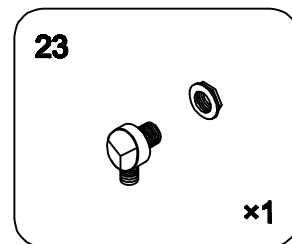
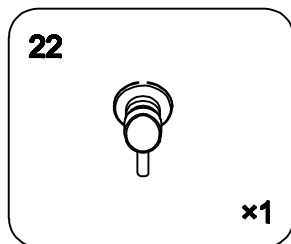
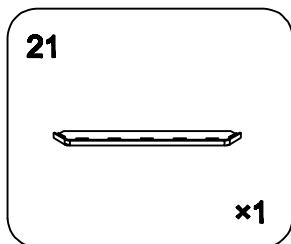
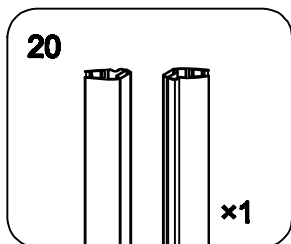
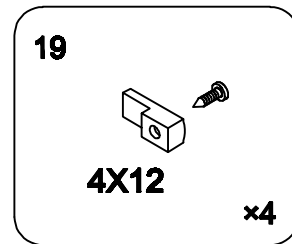
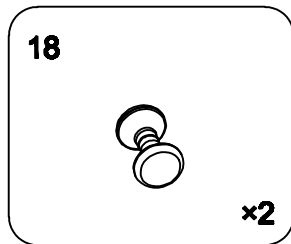
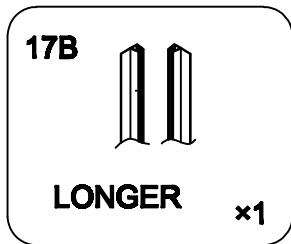
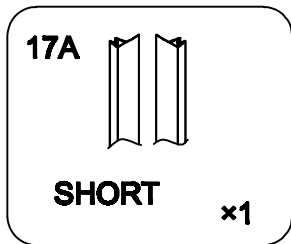
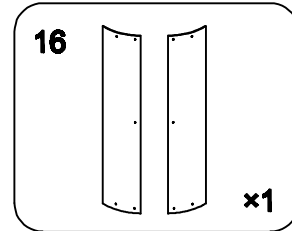
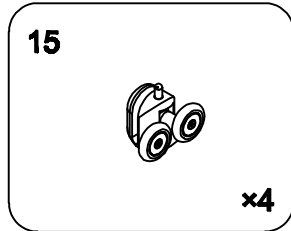
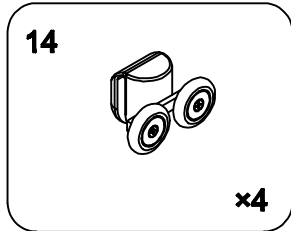
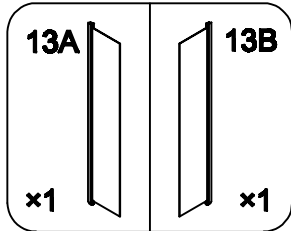
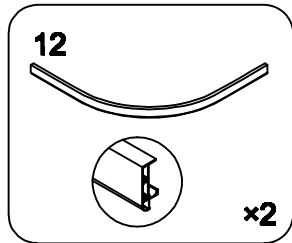
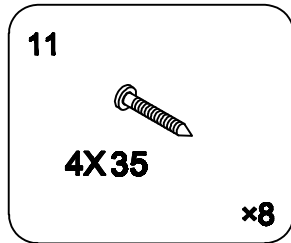
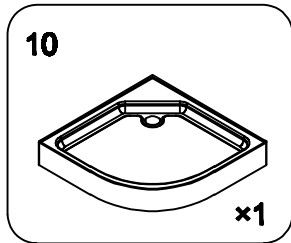
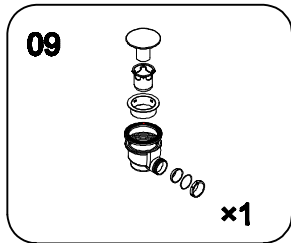
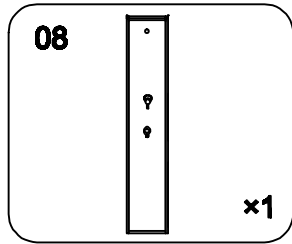
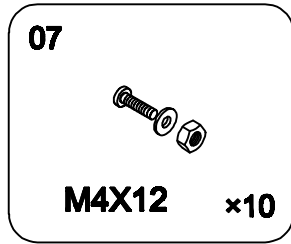
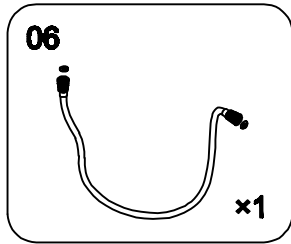
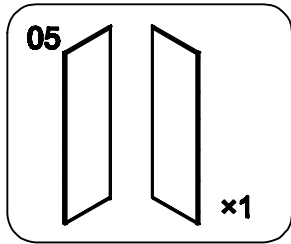
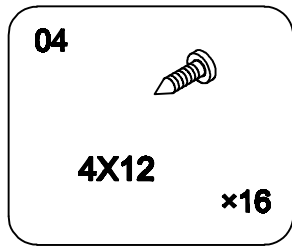
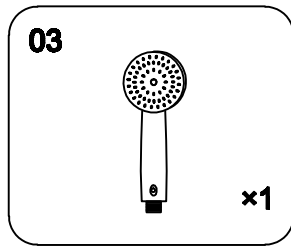
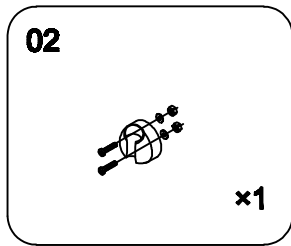
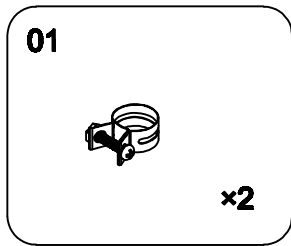

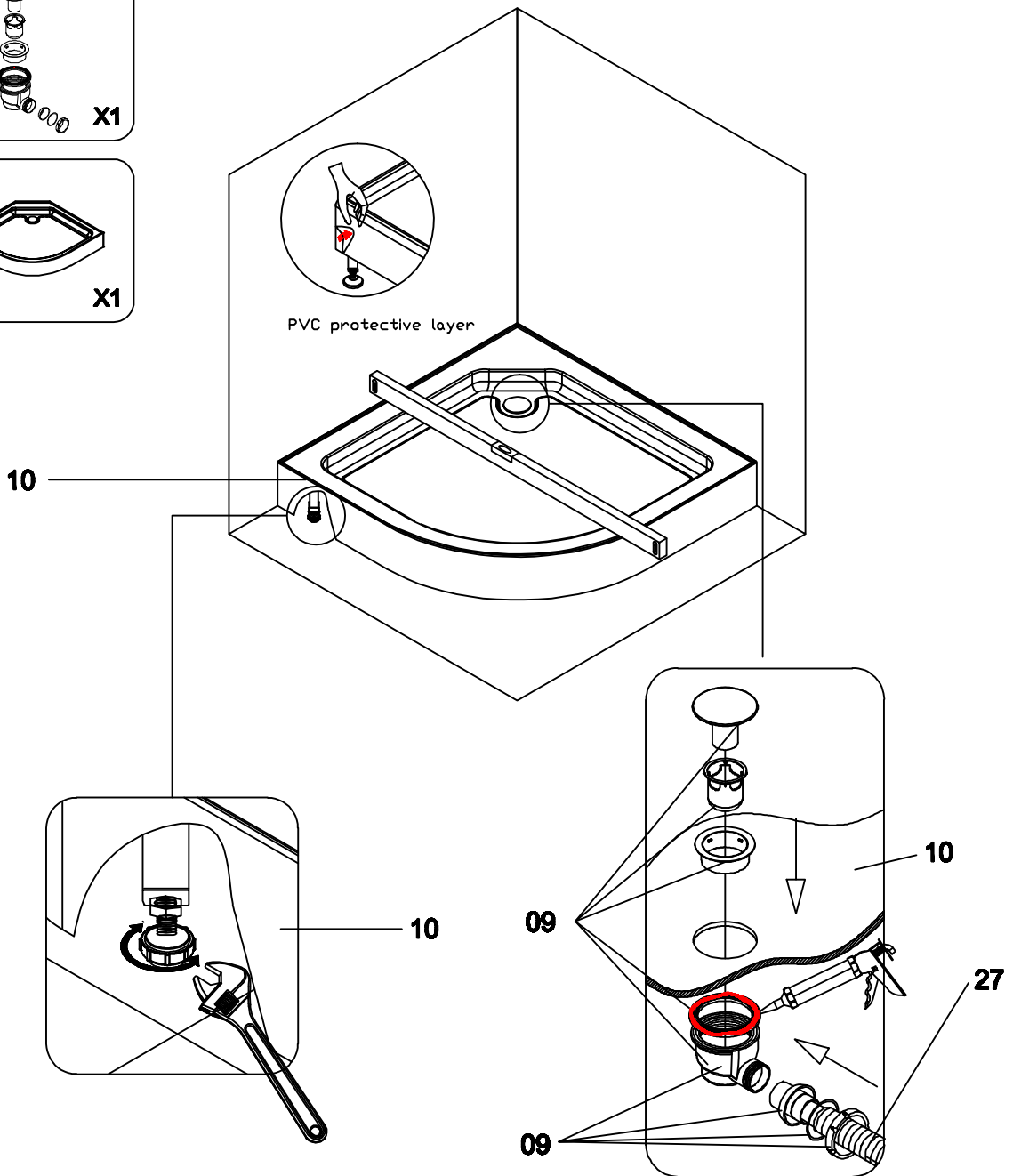
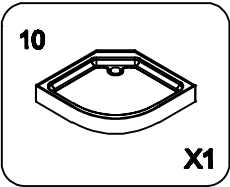
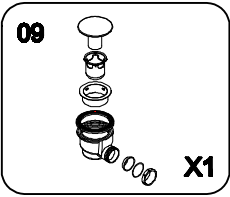
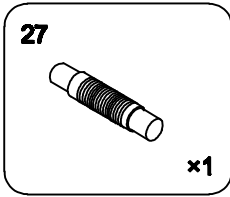
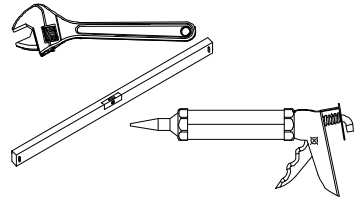

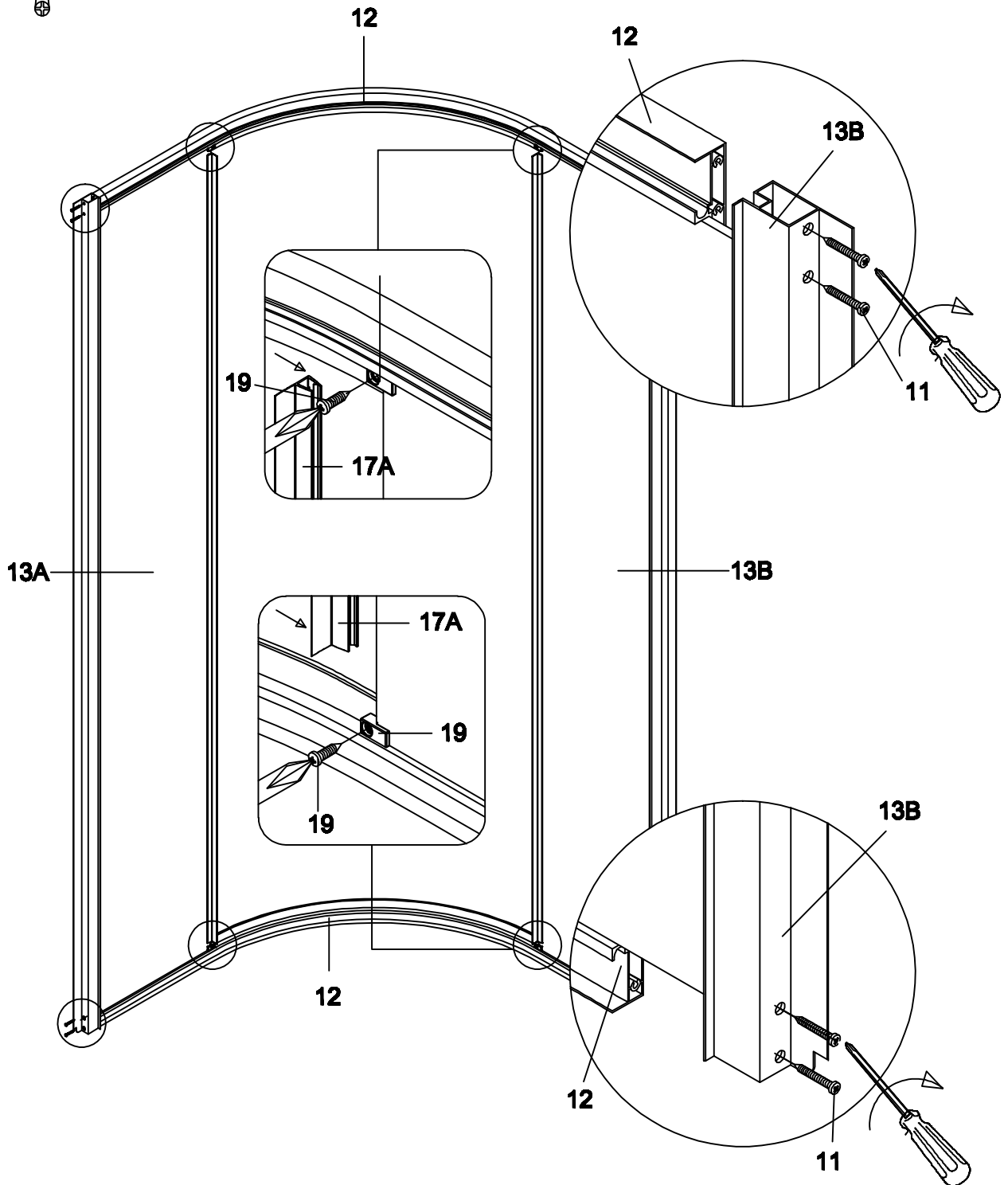
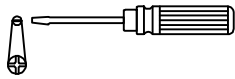
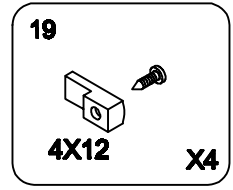
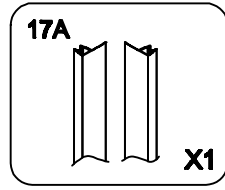
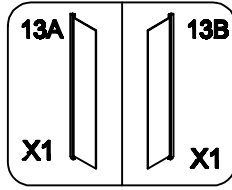
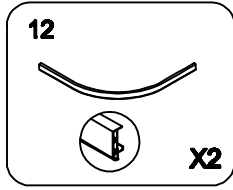
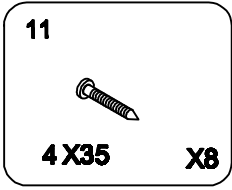

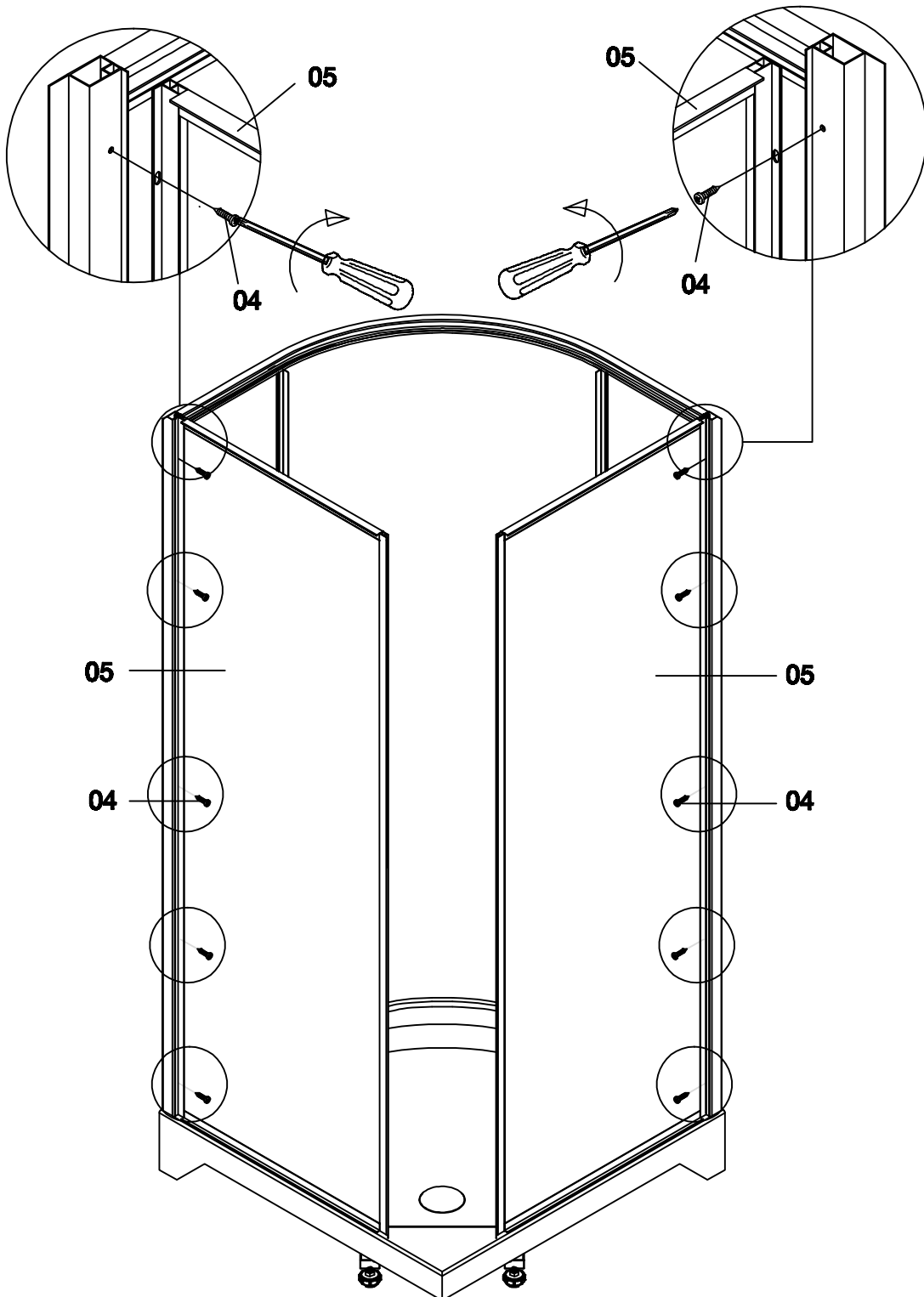
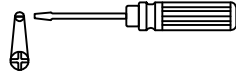
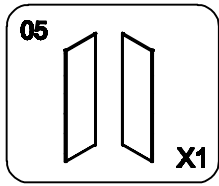
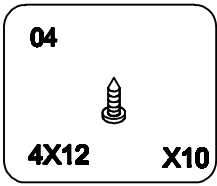

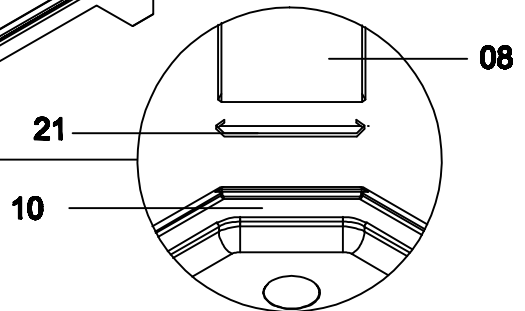
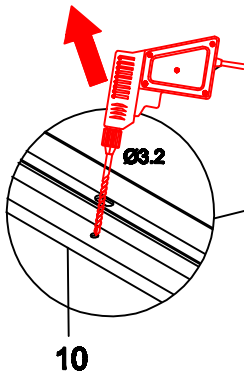
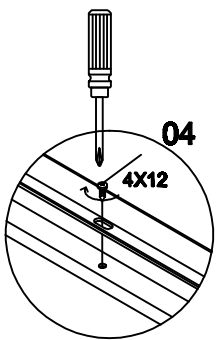
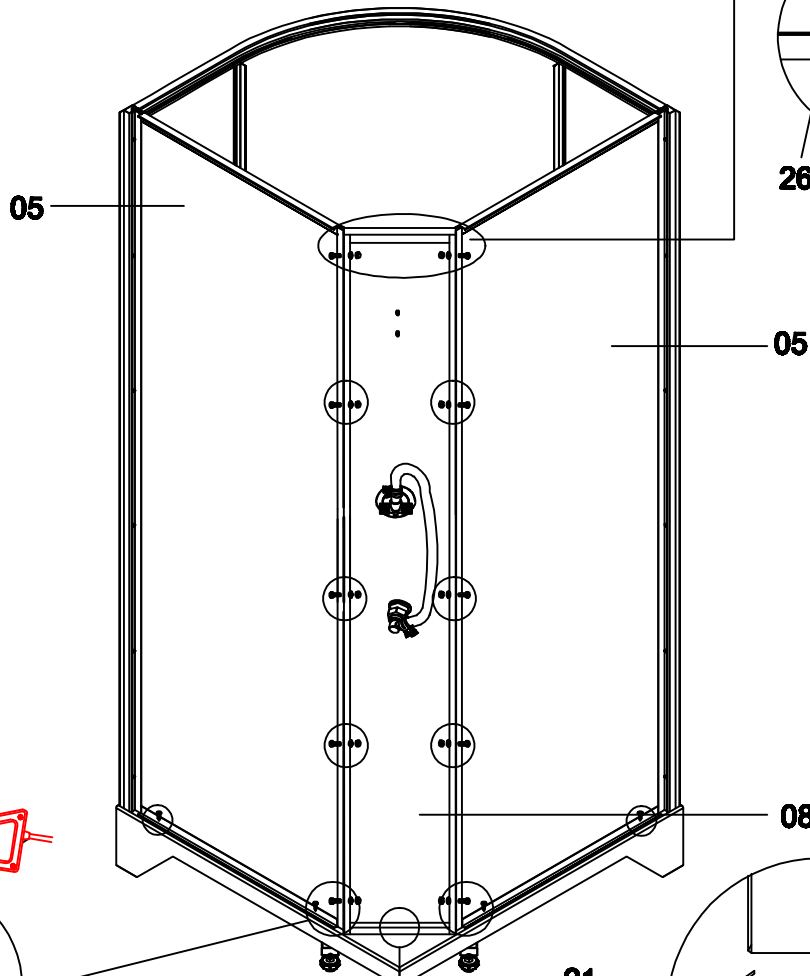
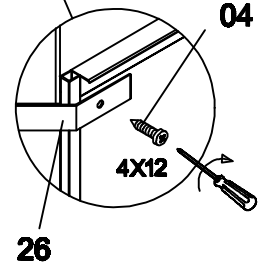
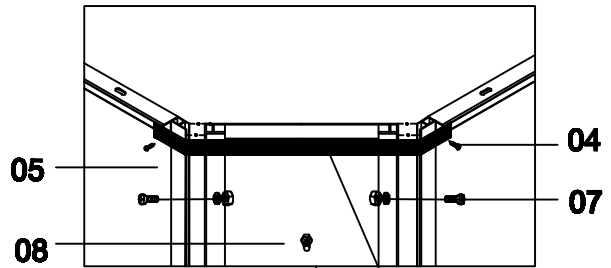
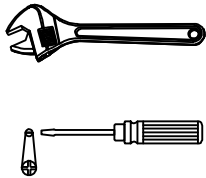
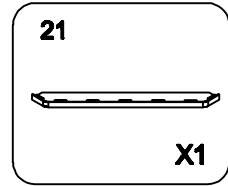
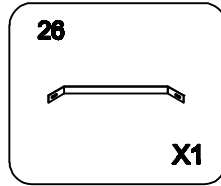
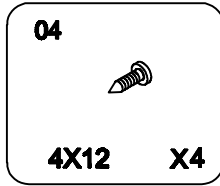
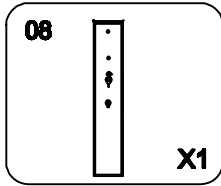
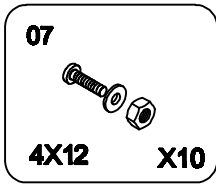

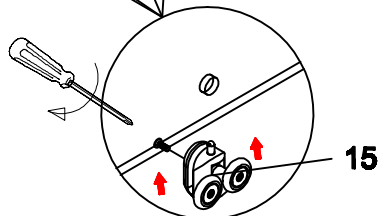
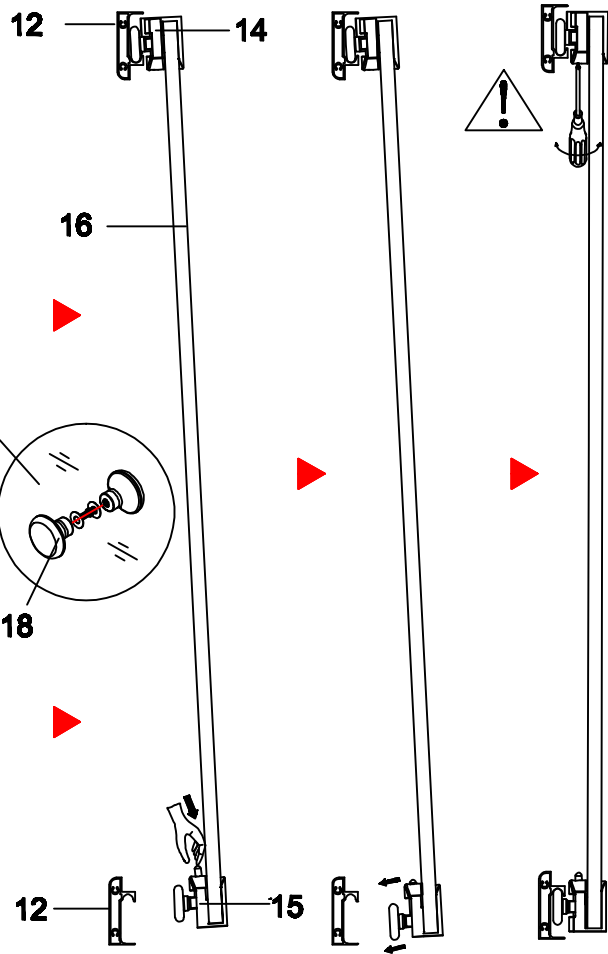
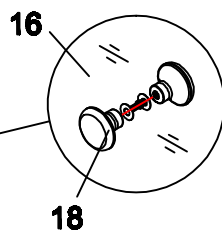
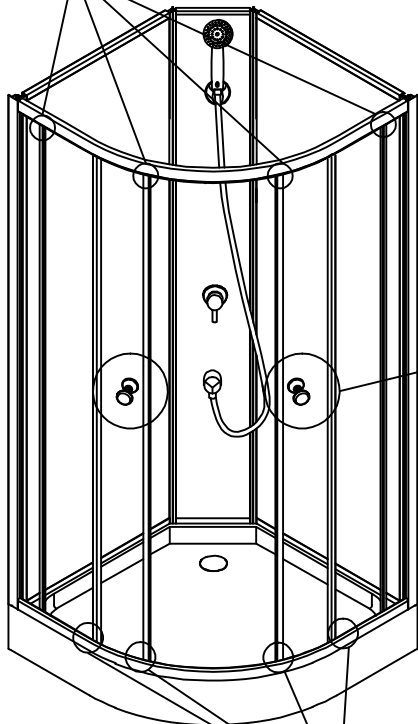
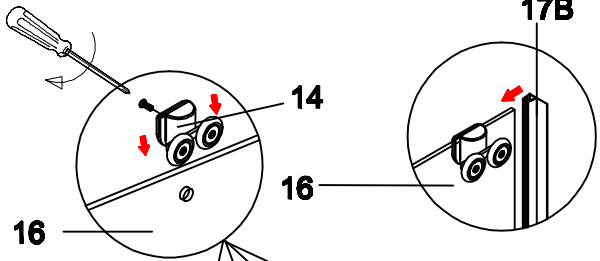
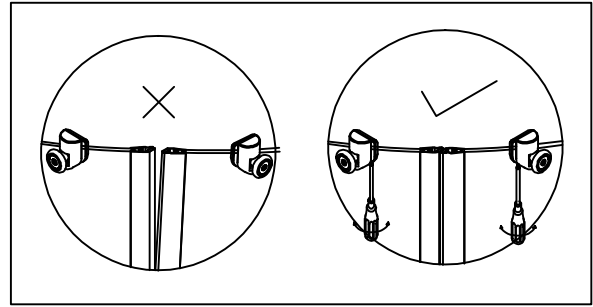
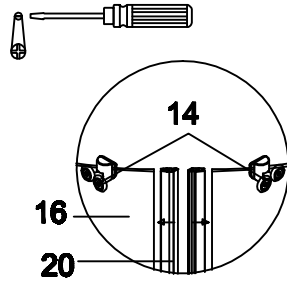
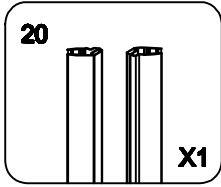
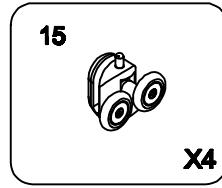
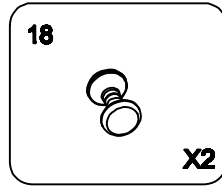
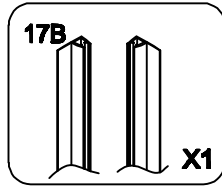
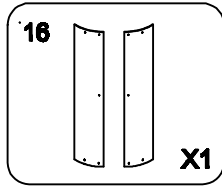
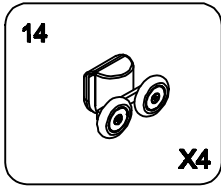

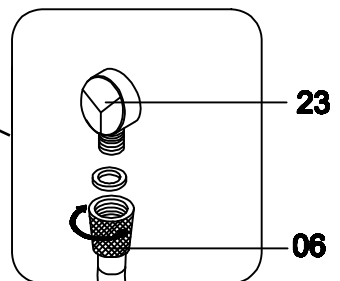
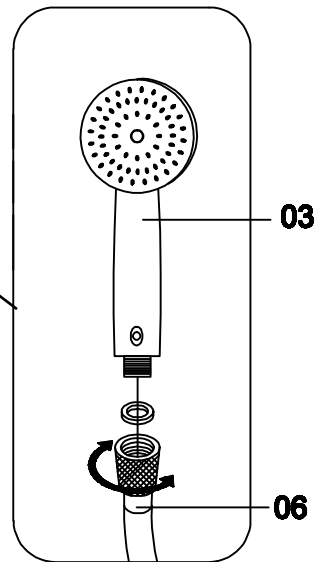
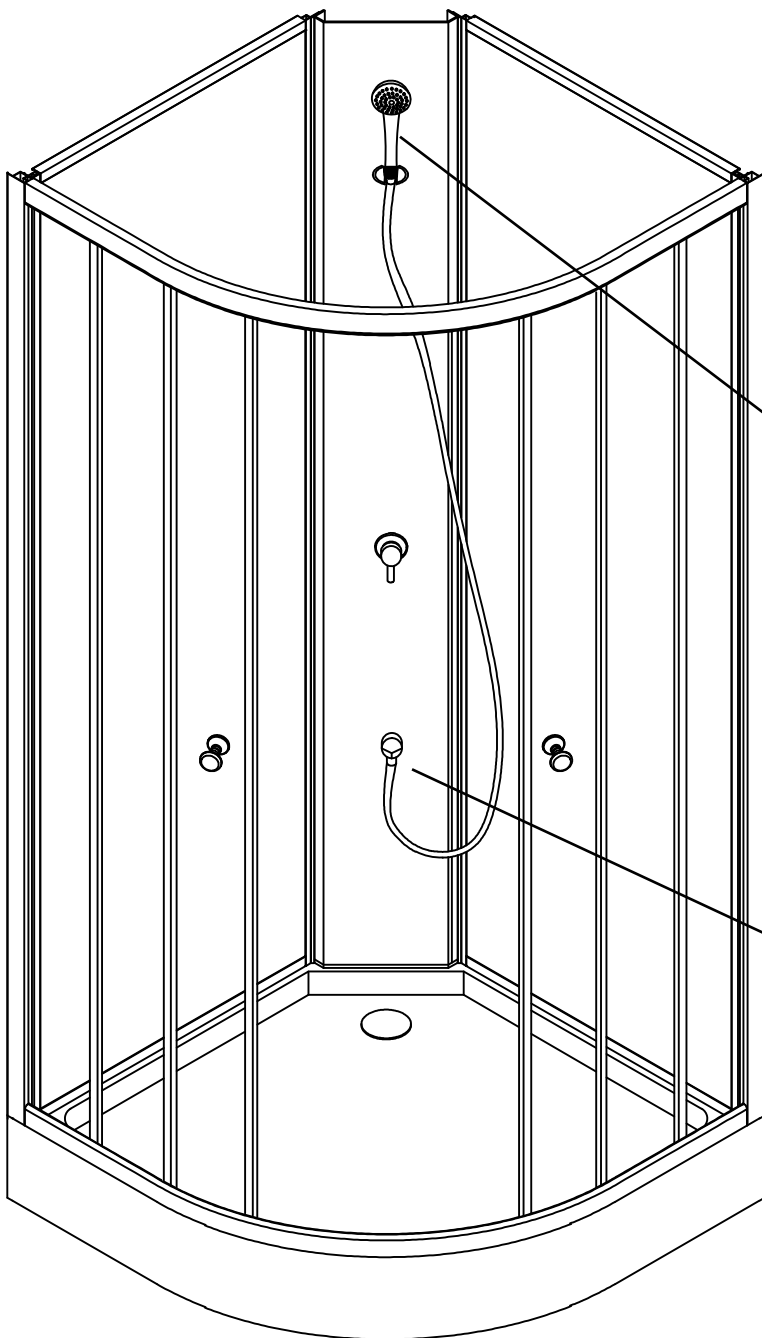
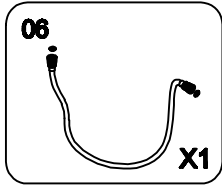
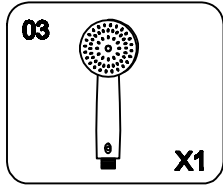

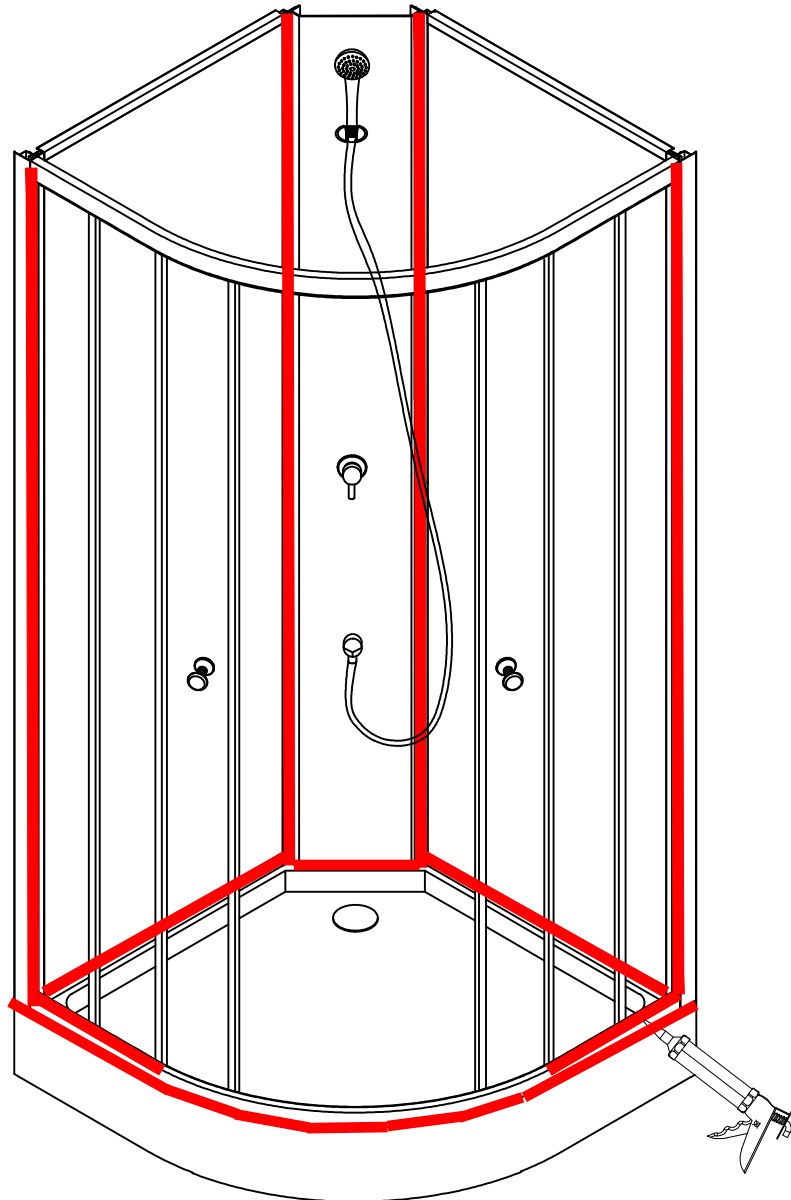
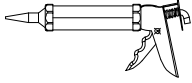



14

Dusar GmbH
An der Strusbek 52a
22926 Ahrensburg Germany
www.dusar.com

Duschkabine 1152085-IIA

Leistungserklärung: KF1439SC1152085II00

EN 14428:2004 + A1:2008

Duschkabine aus Aluminium und Glas

Verwendungszweck: Körperhygiene

Reinigbarkeit : Bestanden
Brucheigenschaften : Bestanden
Dauerhaftigkeit : Bestanden



14

Dusar GmbH
An der Strusbek 52a
22926 Ahrensburg Germany
www.dusar.com

Duschkabine 1152085-IIA

Leistungserklärung: KF1439SC1152085II00

EN 14527:2006 + A1:2010 CL1+CL2

Duschtasse aus ABS und Acryl
Maße : 850x850x155mm

Verwendungszweck: Körperhygiene

Reinigbarkeit : Bestanden
Dauerhaftigkeit : Bestanden



14

Dusar GmbH
An der Strusbek 52a
22926 Ahrensburg Germany
www.dusar.com

shower cabin 1152085-IIA

declaration of performance N° KF1439SC1152085II00

EN 14428:2004 + A1:2008

shower enclosure made of aluminum / glass

intended use : personal hygiene

Cleanability : Pass
Impact resistance &
Shatter property : Pass
Durability : Pass



14

Dusar GmbH
An der Strusbek 52a
22926 Ahrensburg Germany
www.dusar.com

shower cabin 1152085-IIA

declaration of performance N° KF1439SC1152085II00

EN 14527:2006 + A1:2010 CL1+CL2

shower tray made of ABS / acrylic
Dimensions : 850x850x155mm

intended use : personal hygiene

Cleanability : Pass
Durability : Pass